

Litton & Little Longstone with Cressbrook & Litton Mill Parish Statement (draft)



Photo of Litton

The settlement of Litton is closely linked with Tideswell which is located approximately 1 mile north west of Litton. The settlement is equidistance between Buxton, 8 miles west and Bakewell 8 miles south west. Litton has a linear form with a central green around which the school, pub, village hall and shop are located. Historically the village was reliant on agriculture and small scale industry. Litton grew during the 18th in response to lead mining in the surrounding area and then again during the 19th century following the building of the cotton mills at Litton Mill and Cressbrook. Nowadays, the mills have been converted to residential use and the majority of residents who work, commute to nearby cities. Litton Conservation Area was designated in 2008. Litton is located within the limestone village farmlands area of the White Peak as described within the Peak District Landscape Characteristic Assessment (LSAP 2009).

Cressbrook is located approximately 1.25 miles south of Litton and east of Litton Mill. Its Conservation Area was designated in 1986. Cressbrook settlement grew as a direct result of mills built adjacent to the River Wye and associated workers housing. The first mill is thought to have been built in 1604 and the current mill built in 1816 which closed in 1965 and has been converted to residential use. Cressbrook Conservation Area was designated in 1986. The settlement is located in an area of limestone village farmlands within the LSAP (2009).



Litton & Little Longstone with Cressbrook & Litton Mill Parish Statement (draft)



Little Longstone lies between Great Longstone and Monsal Head and has strong links with Great Longstone for community facilities and services. However, the Office of National Statistics links it with Litton with regards to census data and as such it is assessed in this manner. Little Longstone as a parish runs from the Great Longstone end, through Monsal Head (front car park and half of pub) and down to upperdale and including upperdale. Therefore the settlements are split between the main area in the village where the pub and chapel lie, then the two holiday accommodation buildings/hotel/part of pub and cafe (Monsal head) and then the collection of houses at Upperdale. and of course most of Monsal Dale. Thus the village being very spread out.

Little Longstone has a designated Conservation Area and appraisal completed in 1995. The settlement is linear in form and has a history of lead mining, quarrying and farming. And most of the properties date back to the 18th and 19th centuries as a result of the lead mining boom. Little Longstone straddles two landscape character areas in the White Peak; limestone village farmlands and valley farmlands with villages as described within the LSAP (2009).

Litton Mill was built in 1784 and the accompanying settlement was built for mill workers. The mill manufactured yarn for hosiery and continued to do so on and off until it closed in 1986. It has now been converted into residential use. Litton Mill lies in the valley floor of the River Wye within the White Peak.



Litton & Little Longstone with Cressbrook
& Litton Mill Parish Statement (draft)



Community aspirations



Litton & Little Longstone with Cressbrook
& Litton Mill Parish Statement (draft)



Population and Demographics

Population Age Range

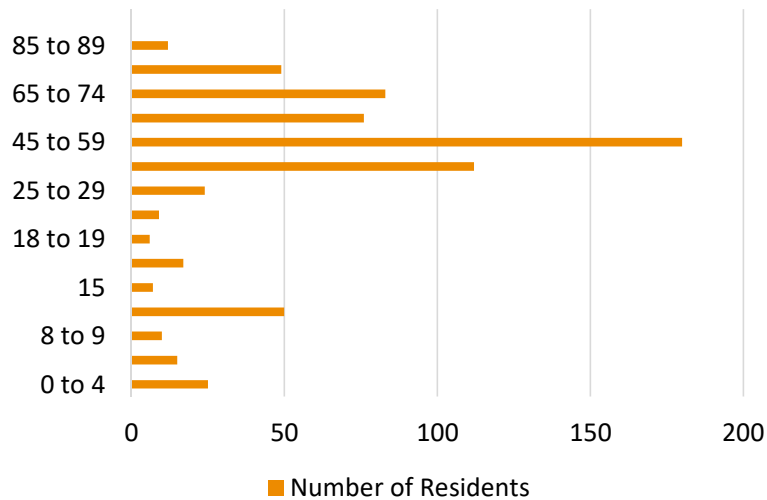

Children, Adults and Older People

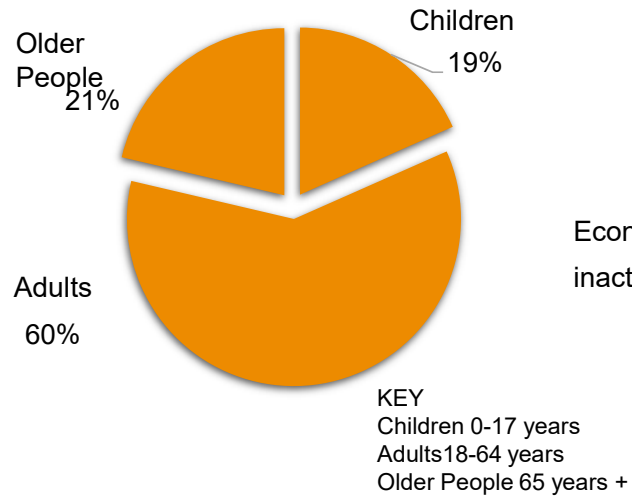

Working and Non Working Adult Population (18+ years)

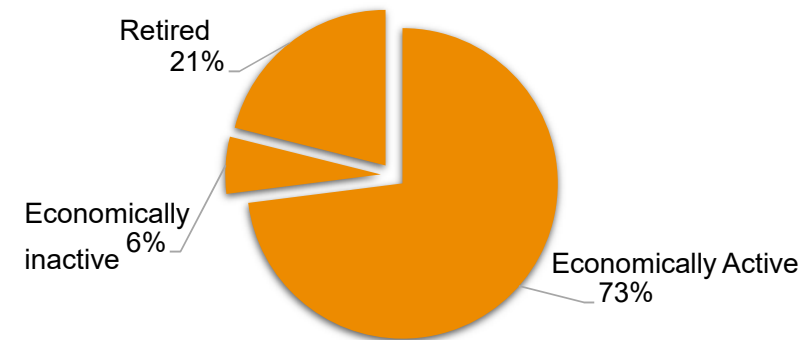

Source: Census 2011

The parishes Litton and Little Longstone have a combined population of 675 (Census 2011).



Litton & Little Longstone with Cressbrook
& Litton Mill Parish Statement (draft)



Housing

Housing Type

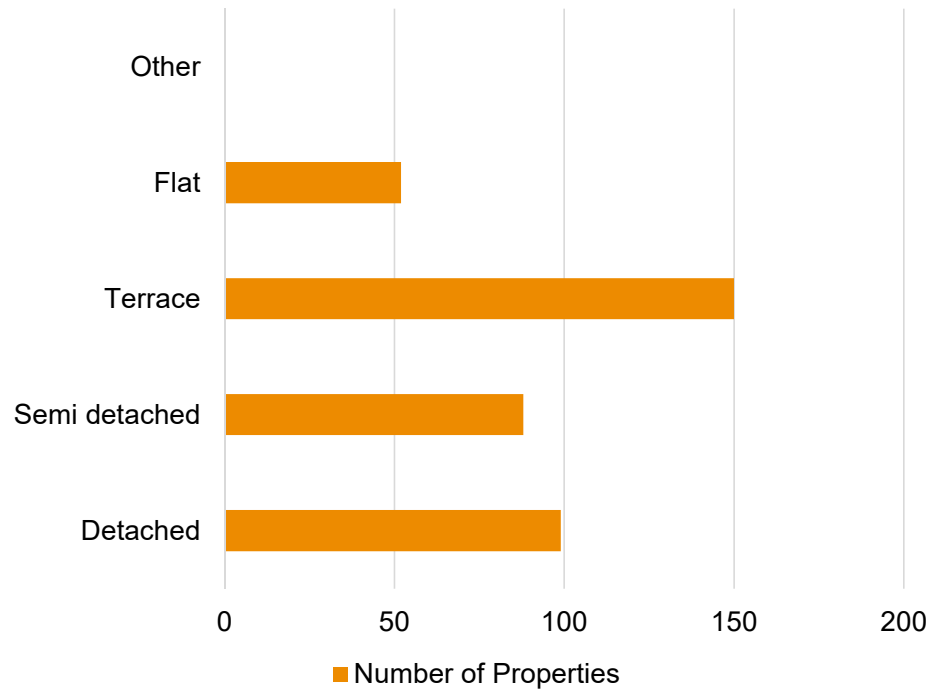

Housing Tenure

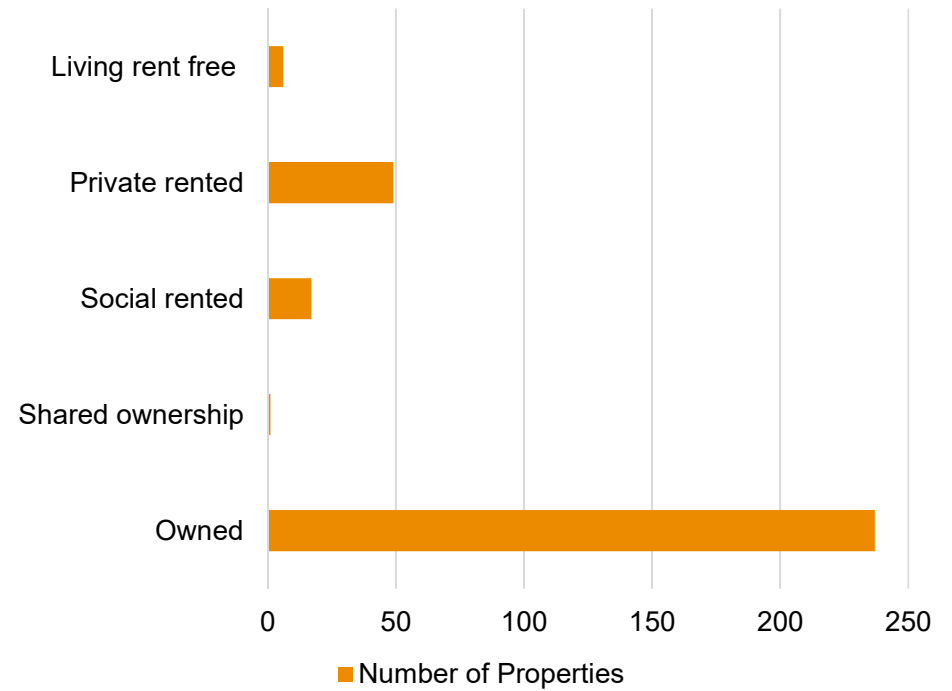

Source: Census 2011



Litton & Little Longstone with Cressbrook
& Litton Mill Parish Statement (draft)



Residency

Occupancy of Properties

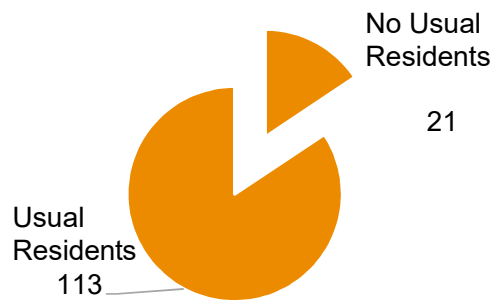

Employment

Occupations of Working Adults

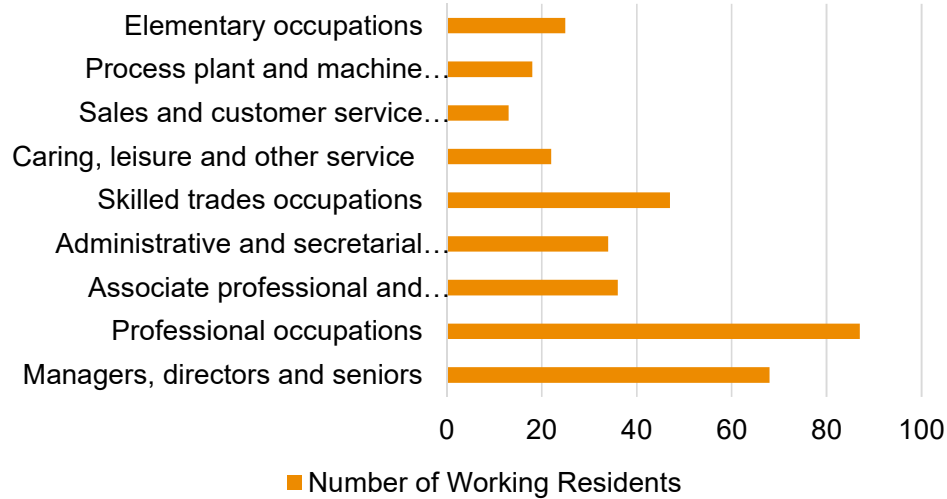

Car/ Van Ownership

Households with a Car/Van

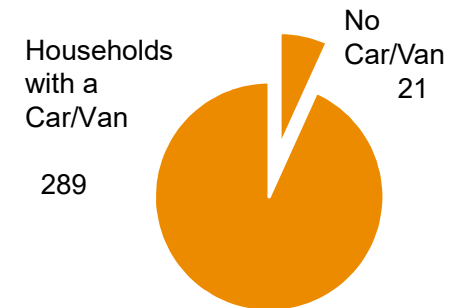

Source: Census 2011



Litton & Little Longstone with Cressbrook & Litton Mill Parish Statement (draft)



Litton Settlement Amenities

Accommodation	★
Events/Traditions	★
Groups	★
Website/Newsletter	★
Conservation Area	★
Car Parking	★
Church	★
Post Box	★
Public House	★
Good Public Transport Route (5+ services a day)	★
Within 1 Mile of an A or B Road	★
Distance to General Practice (miles)	0
Industrial Units	
Playing Field	★
Playground	★
Community Hall	★
Primary School	★
Post Office	★
Convenience Food Shop	★

Key



Is present

Is not present



Litton & Little Longstone with Cressbrook & Litton Mill Parish Statement (draft)



Little Longstone Settlement Amenities

Accommodation	★
Events/Traditions	—
Groups	—
Website/Newsletter	★
Conservation Area	★
Car Parking	—
Church	★
Post Box	★
Public House	★
Good Public Transport Route (5+ services a day)	★
Within 1 Mile of an A or B Road	★
Distance to General Practice (miles)	2.8
Industrial Units	—
Playing Field	—
Playground	—
Community Hall	—
Primary School	—
Post Office	—
Convenience Food Shop	—

Key



Is present

Is not present



Litton & Little Longstone with Cressbrook & Litton Mill Parish Statement (draft)



Cressbrook Settlement Amenities

Accommodation	★
Events/Traditions	★
Groups	★
Website/Newslatter	★
Conservation Area	★
Car Parking	—
Church	★
Post Box	★
Public House	—
Good Public Transport Route (5+ services a day)	—
Within 1 Mile of an A or B Road	★
Distance to General Practice (miles)	1.6
Industrial Units	—
Playing Field	—
Playground	—
Community Hall	★
Primary School	—
Post Office	—
Convenience Food Shop	—

Key



★ Is present

— Is not present

Litton Mill is a small community which has a post box and telephone box.



Litton & Little Longstone with Cressbrook
& Litton Mill Parish Statement (draft)



Public Transport for Litton

Service	Route	Bus Company	Days	Frequency
65	Buxton—Meadowhall	Stagecoach Chesterfield	Mon-Sun	Mon-Sat Btwn 07:10-17:55, 8 per day. Sun & BH Mon; 08:25, 11:25, 16:25
173	Bakewell—Castleton	Hulleys	Mon-Sat	Btwn 07:26-18:26, 7 per day
174	Castleton—Baslow	Hulleys	Mon-Fri	06:33, 14:40

Public Transport for Little Longstone

Service	Route	Bus Company	Days	Frequency
173	Bakewell—Castleton	Hulleys	Mon-Sat	Btwn 07:34 –16:54, 6 per day

There is no bus service to Cressbrook or Litton Mill.

Source:
<https://www.derbybus.info/times/timetables/>



Litton & Little Longstone with Cressbrook
& Litton Mill Parish Statement (draft)



Litton Access to Essential Services

	Service	Time in Minutes
Walking	General Practice	0-10
	Pharmacy	20-30
	Post Office	0-10
	Primary School	0-10
	Secondary School	60+
	Shop	20-30
Public Transport	General Practice	0-10
	Pharmacy	0-10
	Post Office	0-10
	Primary School	0-10
	Secondary School	20-30
	Shop/Supermarket	10-20

Little Longstone Access to Essential Services

	Service	Time in Minutes
Walking	General Practice	60+
	Pharmacy	60+
	Post Office	30-40
	Primary School	20-30
	Secondary School	60+
	Shop	60+
Public Transport	General Practice	10-20
	Pharmacy	10-20
	Post Office	10-20
	Primary School	0-10
	Secondary School	20-30
	Shop/Supermarket	10-20

Cressbrook Access to Essential Services

	Service	Time in Minutes
Walking	General Practice	30-40
	Pharmacy	30-40
	Post Office	50-60
	Primary School	30-40
	Secondary School	60+
	Shop	50-60
Public Transport	General Practice	-
	Pharmacy	-
	Post Office	-
	Primary School	-
	Secondary School	-
	Shop/Supermarket	-



Litton & Little Longstone with Cressbrook & Litton Mill Parish Statement (draft)



Litton Mill Access to Essential Services

	Service	Time in Minutes
Walking	General Practice	40-50
	Pharmacy	50-60
	Post Office	40-50
	Primary School	40-50
	Secondary School	60+
	Shop	50-60
Public Transport	General Practice	-
	Pharmacy	-
	Post Office	-
	Primary School	-
	Secondary School	-
	Shop/Supermarket	-

Source: Derbyshire County Council

Litton Community

Sports clubs	
General	WI, Tideswell singers, luncheon club, snooker club, meditation, exercise classes, music groups, baby and toddler group
Events/ Traditions	

Little Longstone Community

Sports clubs	
General	Joins with Great Longstone for groups and activities. See Great Longstone parish assessment for further information.
Events/ Traditions	



Litton & Little Longstone with Cressbrook & Litton Mill Parish Statement (draft)



Cressbrook Community

Sports clubs	
General	Cressbrook Village Band, Cressbrook Community Association film club
Events/ Traditions	Cressbrook Produce Show, Cressbrook Fell Race, Cressbrook Gala Week

Litton Mill Community (tbc)

Sports clubs	
General	
Events/ Traditions	

Planning

Over the last 5 years 36 planning applications have been approved.

Digital presence

<https://www.littonparishcouncil.com/>
[http://www.greatlongstone.net/index? ts=15815](http://www.greatlongstone.net/index?ts=15815)
<http://www.undertheedge.net/>
<http://www.cressbrookclub.org.uk/>

Affordable Housing

There are no plans to build affordable housing in the parish at present.



Litton & Little Longstone with Cressbrook
& Litton Mill Parish Statement (draft)



Litton and its Services



Key

- A1 Shops
- A2 Financial and Professional Services
- A3 Restaurants and Cafes
- A4 Drinking Establishments
- A5 Hot Food Takeaways
- B1 Business
- B2 General Industrial
- B8 Storage or Distribution
- C1 Hotels
- C2 Residential Institutions
- C2A Secure Residential Institution
- C3 Dwellinghouses
- C4 Houses in Multiple Occupation
- D1 Non-Residential Institutions
- D2 Assembly and Leisure
- Camp Site
- Allotments
- Playground
- Playing Field
- Public Car Park
- Sui Generis
- Bus Stop
- Notice Board
- Post Box
- Telephone Box
- Cash Point
- Public Toilets
- Defibrillator



Litton & Little Longstone with Cressbrook
& Litton Mill Parish Statement (draft)



Little Longstone and its Services



Key

- A1 Shops
- A2 Financial and Professional Services
- A3 Restaurants and Cafes
- A4 Drinking Establishments
- A5 Hot Food Takeaways
- B1 Business
- B2 General Industrial
- B8 Storage or Distribution
- C1 Hotels
- C2 Residential Institutions
- C2A Secure Residential Institution
- C3 Dwellinghouses
- C4 Houses in Multiple Occupation
- D1 Non-Residential Institutions
- D2 Assembly and Leisure
- Camp Site
- Allotments
- Playground
- Playing Field
- Public Car Park
- Sui Generis
- Bus Stop
- Notice Board
- Post Box
- Telephone Box
- Cash Point
- Public Toilets
- Defibrillator



Litton & Little Longstone with Cressbrook
& Litton Mill Parish Statement (draft)



Cressbrook and its Services

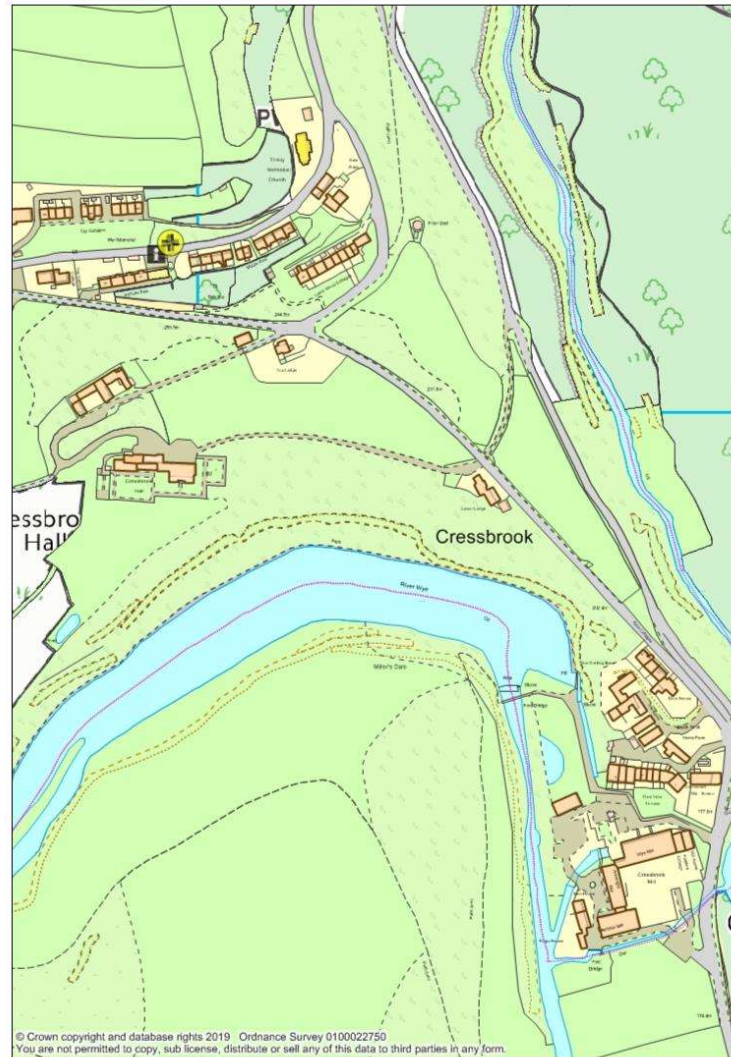

Key

- A1 Shops
- A2 Financial and Professional Services
- A3 Restaurants and Cafes
- A4 Drinking Establishments
- A5 Hot Food Takeaways
- B1 Business
- B2 General Industrial
- B8 Storage or Distribution
- C1 Hotels
- C2 Residential Institutions
- C2A Secure Residential Institution
- C3 Dwellinghouses
- C4 Houses in Multiple Occupation
- D1 Non-Residential Institutions
- D2 Assembly and Leisure
- Camp Site
- Allotments
- Playground
- Playing Field
- Public Car Park
- Sui Generis
- Bus Stop
- Notice Board
- Post Box
- Telephone Box
- Cash Point
- Public Toilets
- Defibrillator



Litton & Little Longstone with Cressbrook & Litton Mill Parish Statement (draft)



Litton Mill and its Services

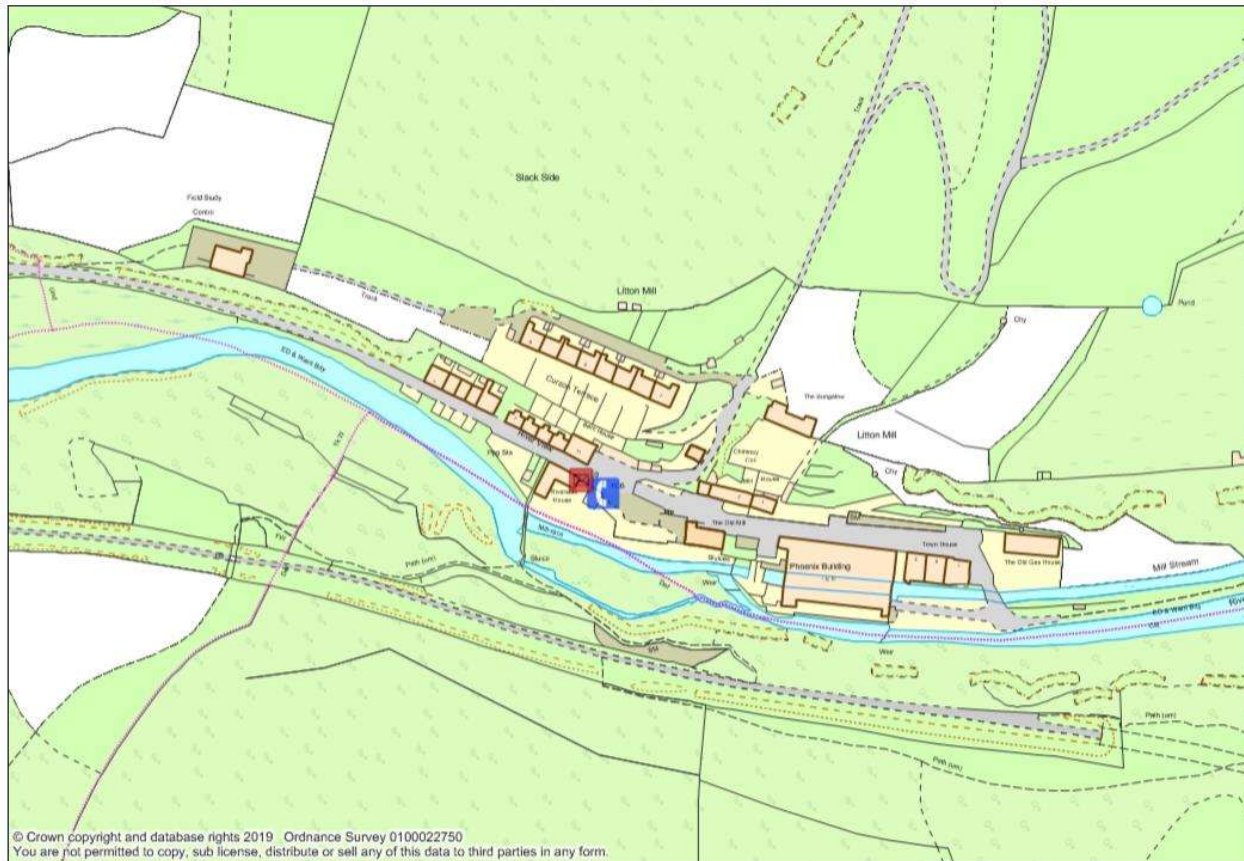

Key

- A1 Shops
- A2 Financial and Professional Services
- A3 Restaurants and Cafes
- A4 Drinking Establishments
- A5 Hot Food Takeaways
- B1 Business
- B2 General Industrial
- B8 Storage or Distribution
- C1 Hotels
- C2 Residential Institutions
- C2A Secure Residential Institution
- C3 Dwellinghouses
- C4 Houses in Multiple Occupation
- D1 Non-Residential Institutions
- D2 Assembly and Leisure
- Camp Site
- Allotments
- Playground
- Playing Field
- Public Car Park
- Sui Generis
- Bus Stop
- Notice Board
- Post Box
- Telephone Box
- Cash Point
- Public Toilets
- Defibrillator



Litton & Little Longstone with Cressbrook
& Litton Mill Parish Statement (draft)



**PEAK
DISTRICT
NATIONAL
PARK**

Litton & Little Longstone Parish Boundaries

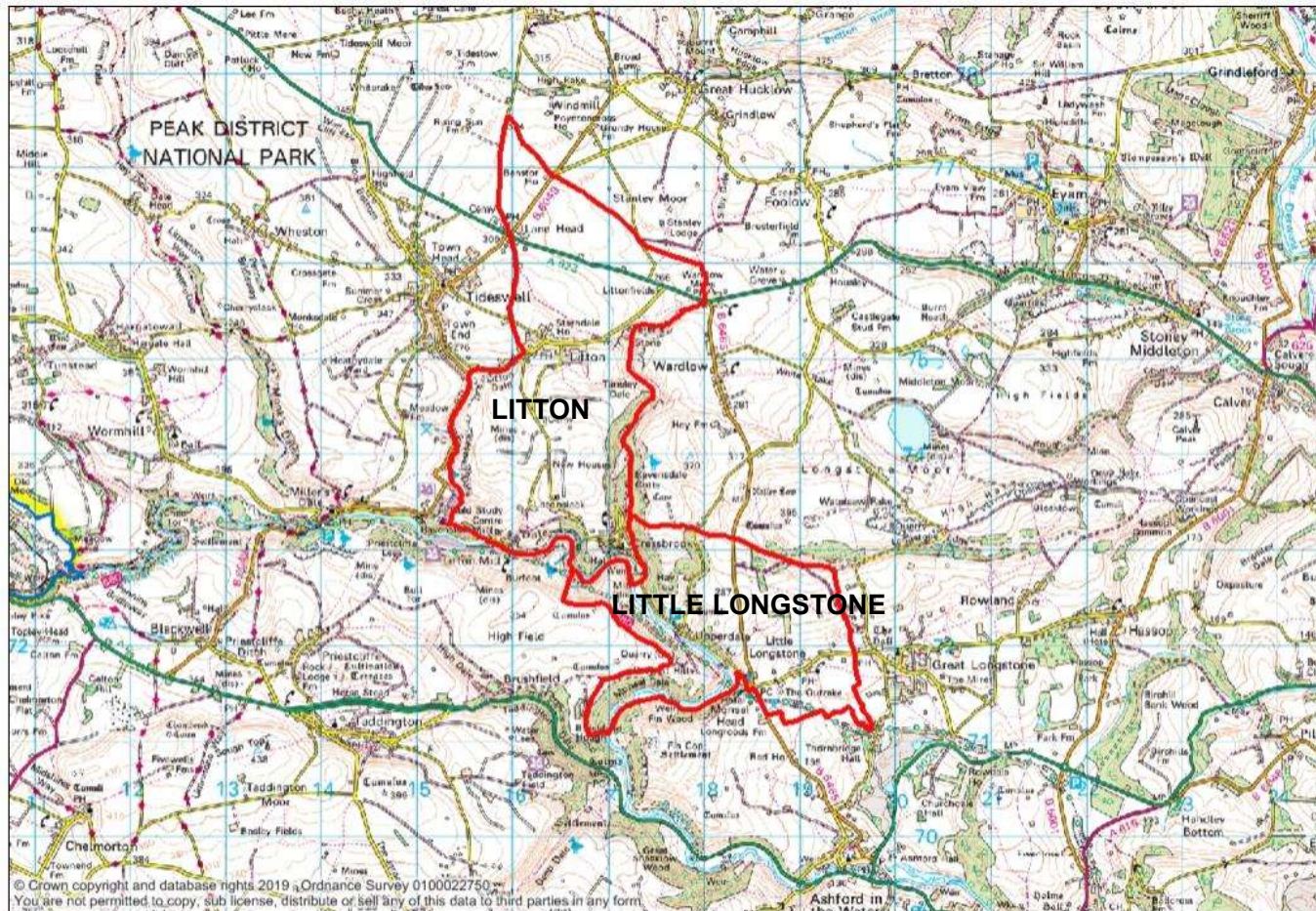



Litton & Little Longstone with Cressbrook
& Litton Mill Parish Statement (draft)



Data sources

Peak District National Park Conservation Area Appraisals

Peak District National Park Landscape Strategy Action Plan (LSAP)

www.nomisweb.co.uk

Ordnance survey maps

Derbyshire Accessibility Assessment 2016, Derbyshire County Council

<http://www.derbybus.info/times/timetables/>

<https://www.nhs.uk/service-search/>